

# Mussell Wheels

ASF =  
Axle Single  
Flange

All dimensions are  
in millimeters  
(top table)  
& inches  
(bottom table).

All axles modules  
are made of  
ductile iron castings  
Grade 80-55-60.

Holes tapped  
N.C.

## MUSSELL CRANE MFG.

620-B Wellington Avenue,  
P.O. Box 253, Station Main,  
Chilliwack, B.C. Canada  
V2P 6J1

Phone: 604-792-5023

Fax: 604-792-5038

Email: info@mussellcrane.com

*"Proudly Canadian"*

## STANDARD AXLE MODULES FOR SINGLE FLANGE WHEELS DIMENSIONAL DATA

*Millimeters*

MODEL	A	B Axle	C	D	E	F	G	H Tapped	J
ASF120	66.83	30	6.35	30	79.38	101.6	12.7	½" N.C.	34.93
ASF153	80.49	45	6.35	30	111.13	139.7	15.88	5/8" N.C.	38.10

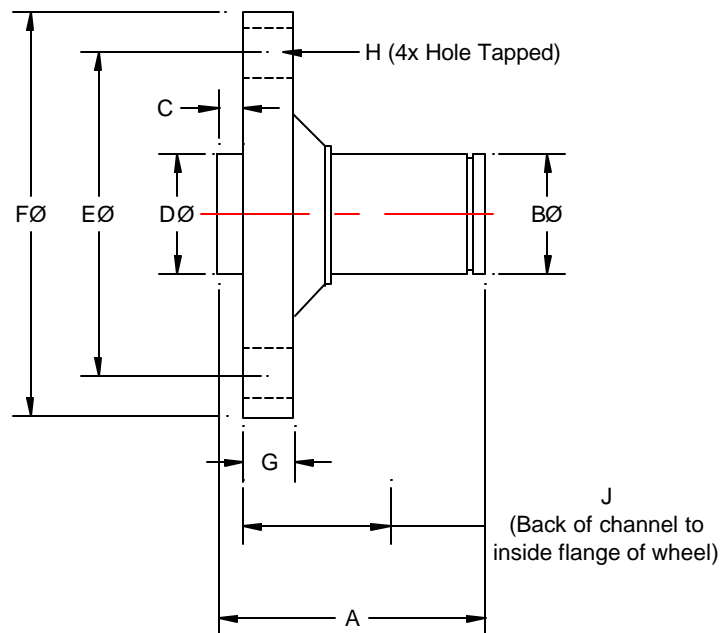

*Inches*

MODEL	A	B Axle	C	D	E	F	G	H Tapped	J
ASF120	2.631"	1.181"	.250"	1.181"	3.125"	4.000"	.500"	.500" N.C.	1.375"
ASF153	3.169"	1.771"	.250"	1.181"	4.375"	5.500"	.625"	.625" N.C.	1.50"