

Mussell Wheels

M= Module
T-Tooth

STD = Standard
OPT = Optional

All Module 3 Pinions
With 20 Degree
Pressure Angle.

All pinions are
made of 4140
heat treated
stress relief steel.

Key Charge
Extra \$10.00

Set Screw Charge
Extra \$6.00

MUSSELL CRANE MFG.

620-B Wellington Avenue,
P.O. Box 253, Station Main,
Chilliwack, B.C. Canada
V2P 6J1

Phone: 604-792-5023

Fax: 604-792-5038

Email: info@mussellcrane.com

"Proudly Canadian"

STANDARD CROSS SHAFT PINION DIMENSIONAL DATA

Millimeters

Model	A	C	E	F	Bore	Wheel (mm)
M3/20T-CS	66	26.16	2.79 2.87	25.4	25.4 STD 31.75 OPT	120 153
M3/23T-CS	75	26.16	2.79 2.87	25.4	25.4 STD 31.75 OPT	120 153
M3/26T-CS	84	26.16	2.79 2.87	25.4	25.4 STD 31.75 OPT	120 153

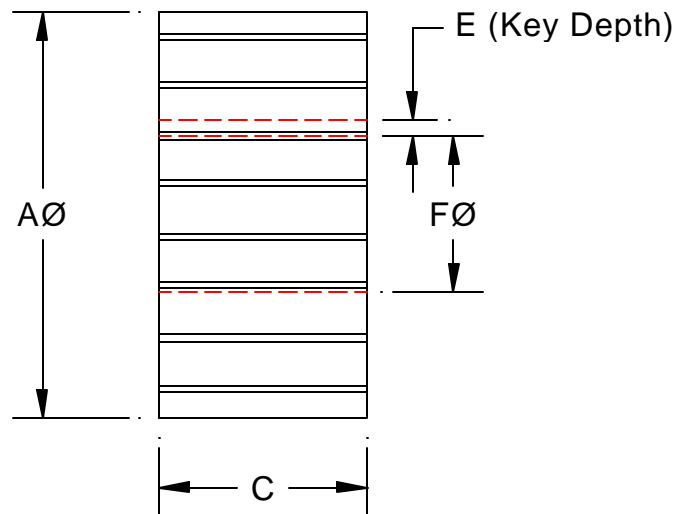

Inches

Model	A	C	E	F	Bore	Key Size	Wheel (mm)
M3/20T-CS	2.598	1.030	0.110 0.113	1.000	1.000 STD 1.250 OPT	¼" ¼"	120 153
M3/23T-CS	2.953	1.030	0.110 0.113	1.000	1.000 STD 1.250 OPT	¼" ¼"	120 153
M3/26T-CS	3.307	1.030	0.110 0.113	1.000	1.000 STD 1.250 OPT	¼" ¼"	120 153